

in collaborazione con:



**DICEA**

Dipartimento di Ingegneria Civile, Edile ed Ambientale  
Università di Padova

---

## **Opzioni di intervento nel miglioramento sismico di edifici esistenti**



**ing. Roberto Scotta**

e.mail: [roberto.scotta@unipd.it](mailto:roberto.scotta@unipd.it)

**Università di Padova**

**Dipart. Ingegneria Civile Edile e Ambientale**

## Effetto dinamico del sisma sulle costruzioni



## Curva di capacità (statica)

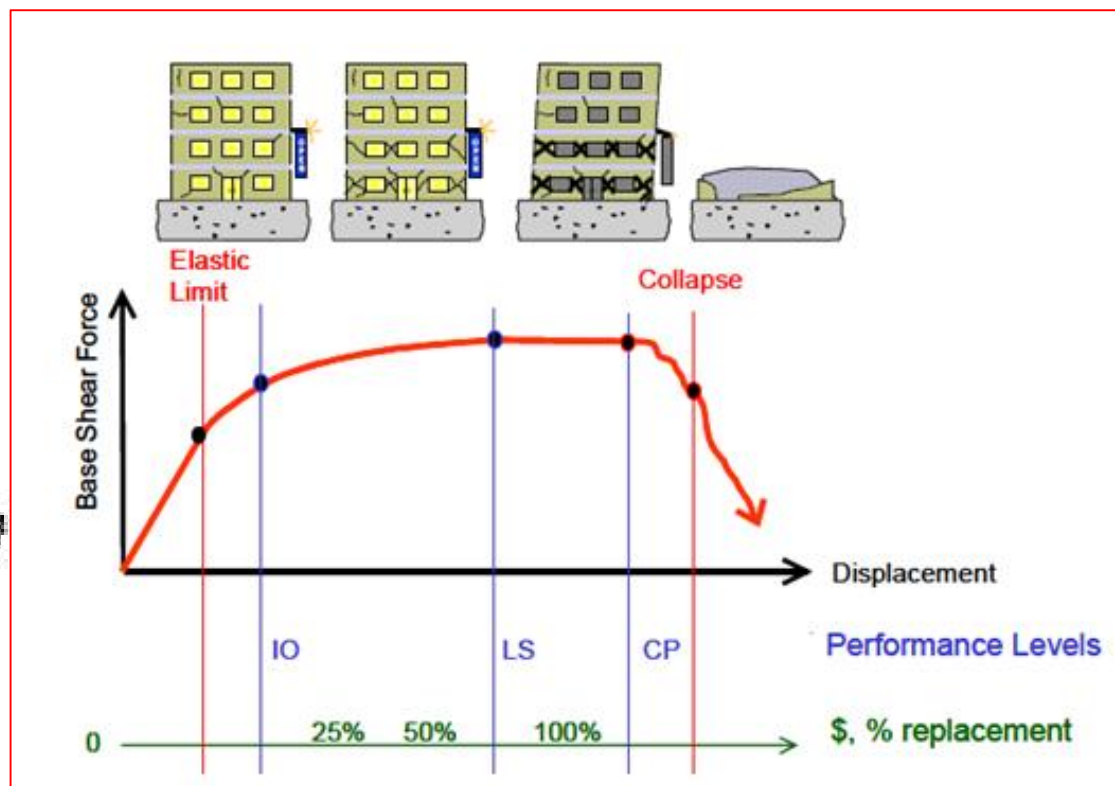
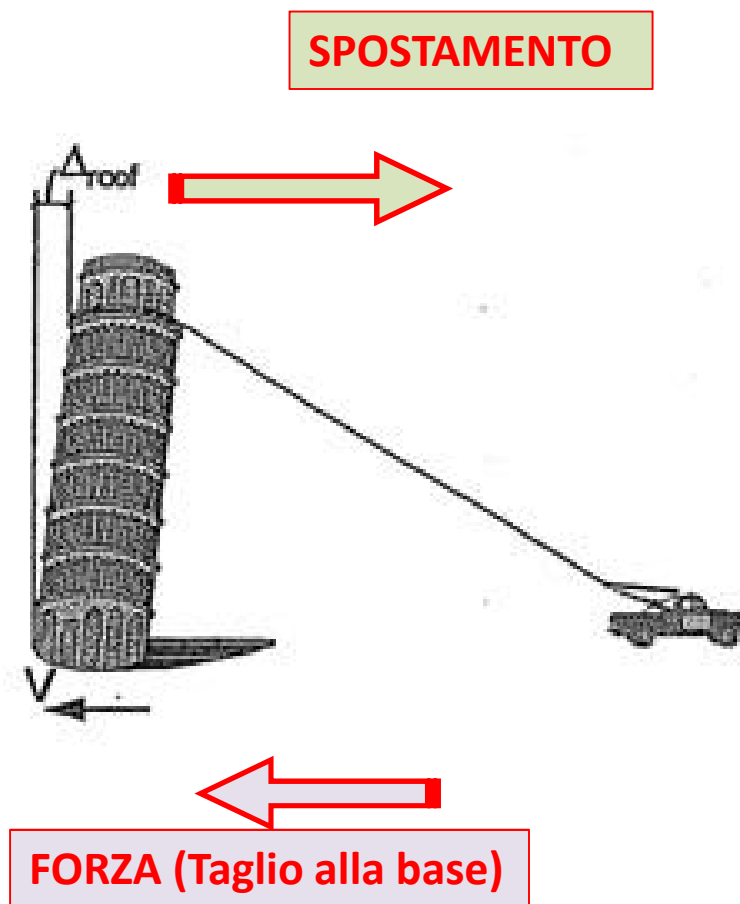

## Domanda sismica (statica)

Taglio alla base / Peso edificio

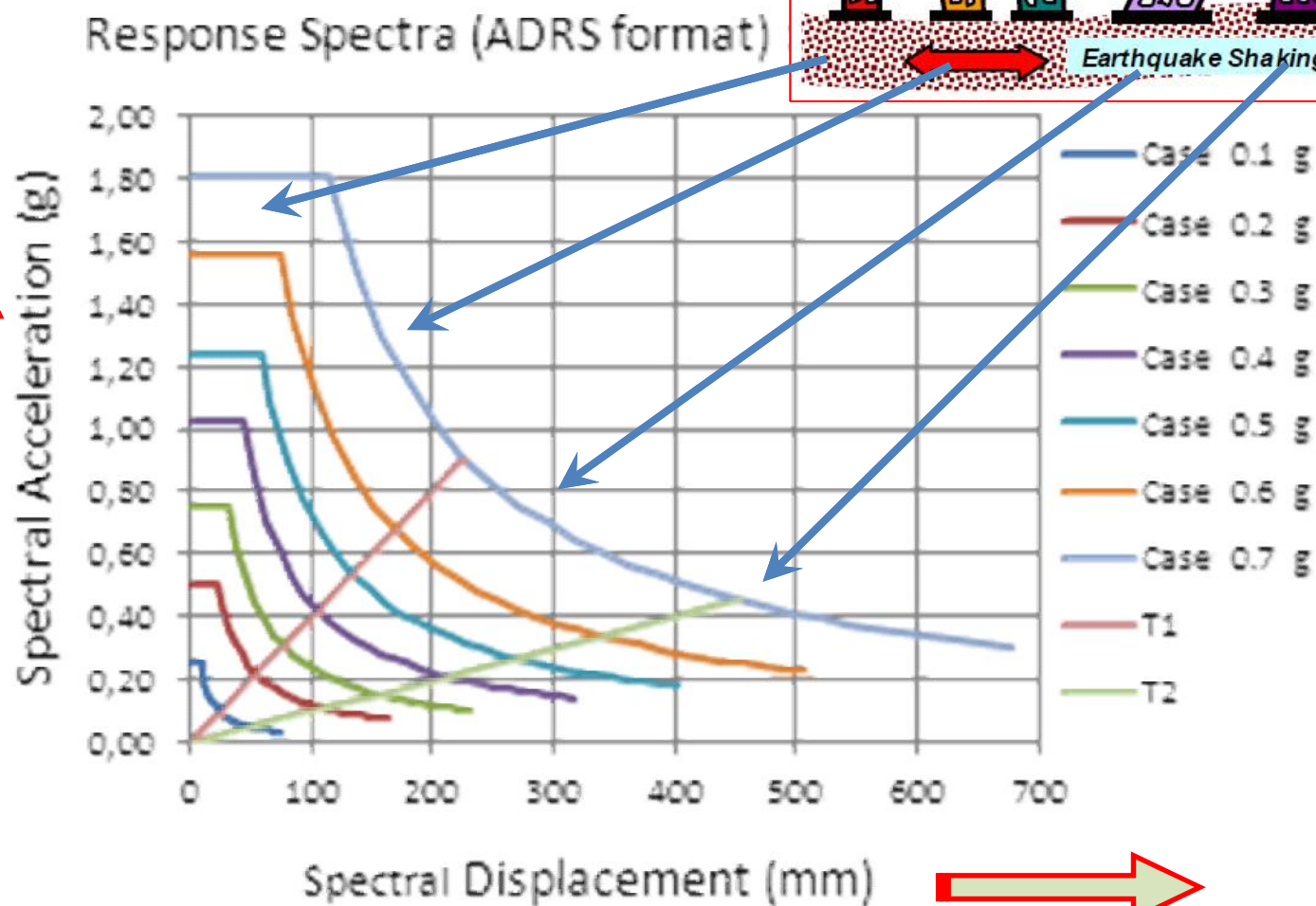

## Confronto capacità domanda

Taglio alla base / Peso edificio

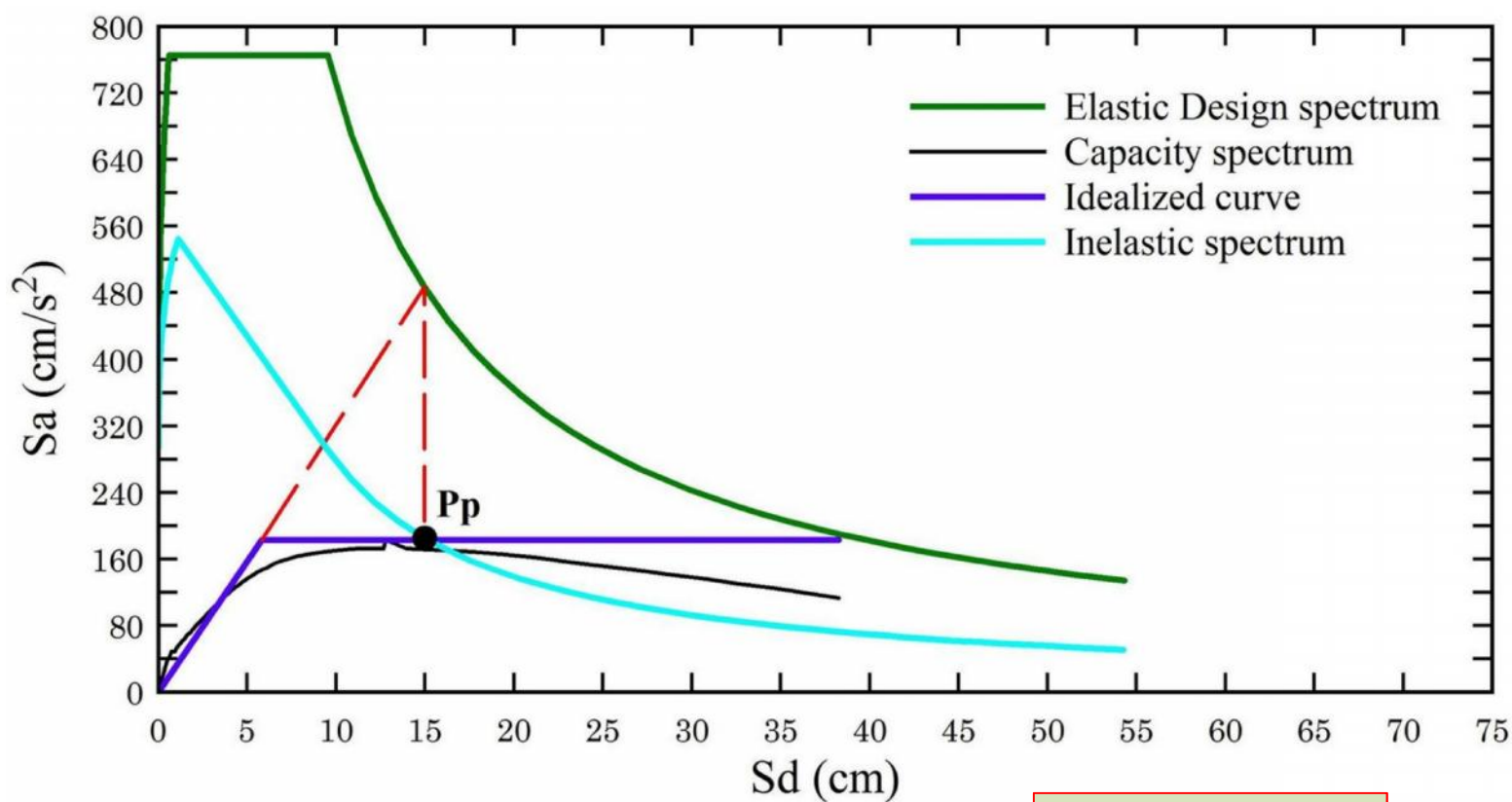

**SPOSTAMENTO**



## Opzioni di miglioramento/adeguamento sismico



bunker

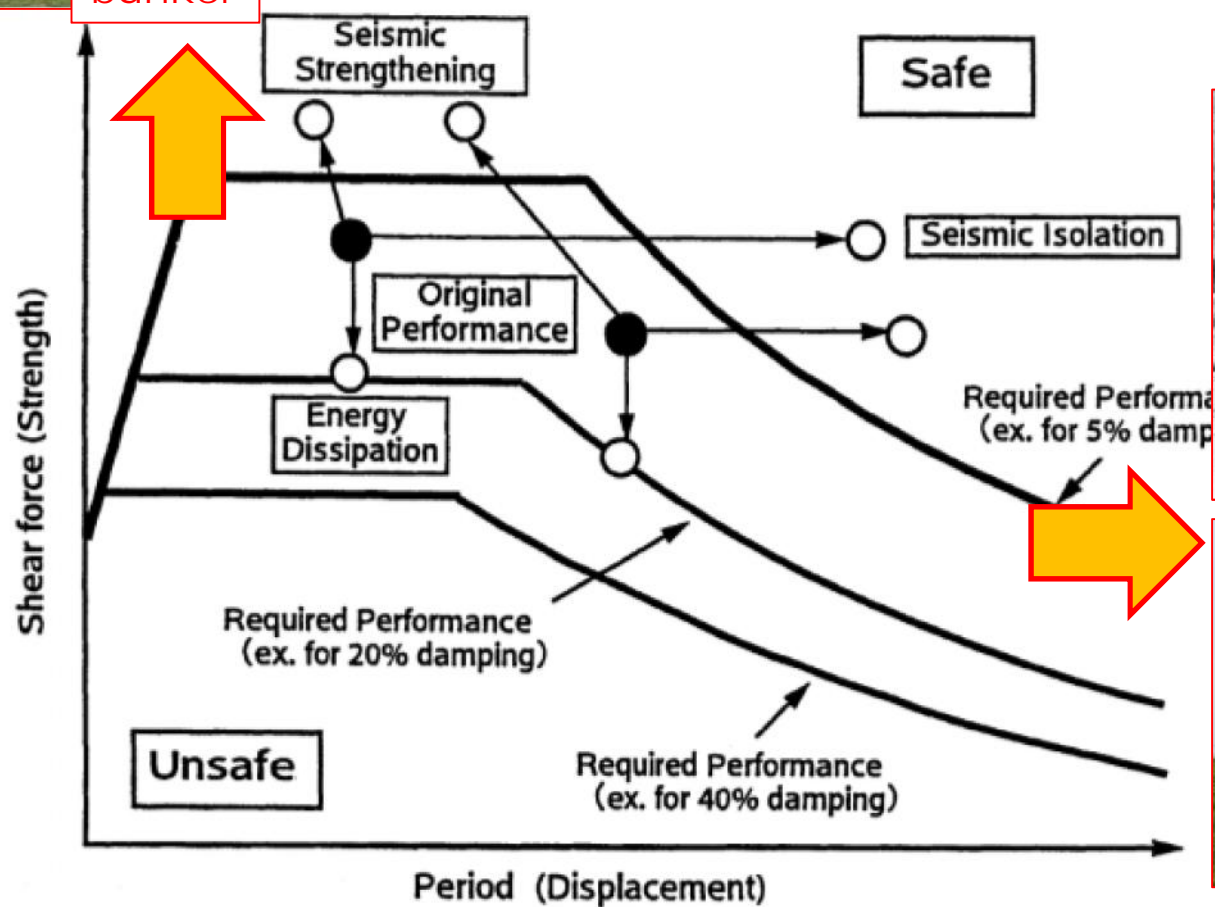

flessibilità

# Opzioni di adeguamento sismico

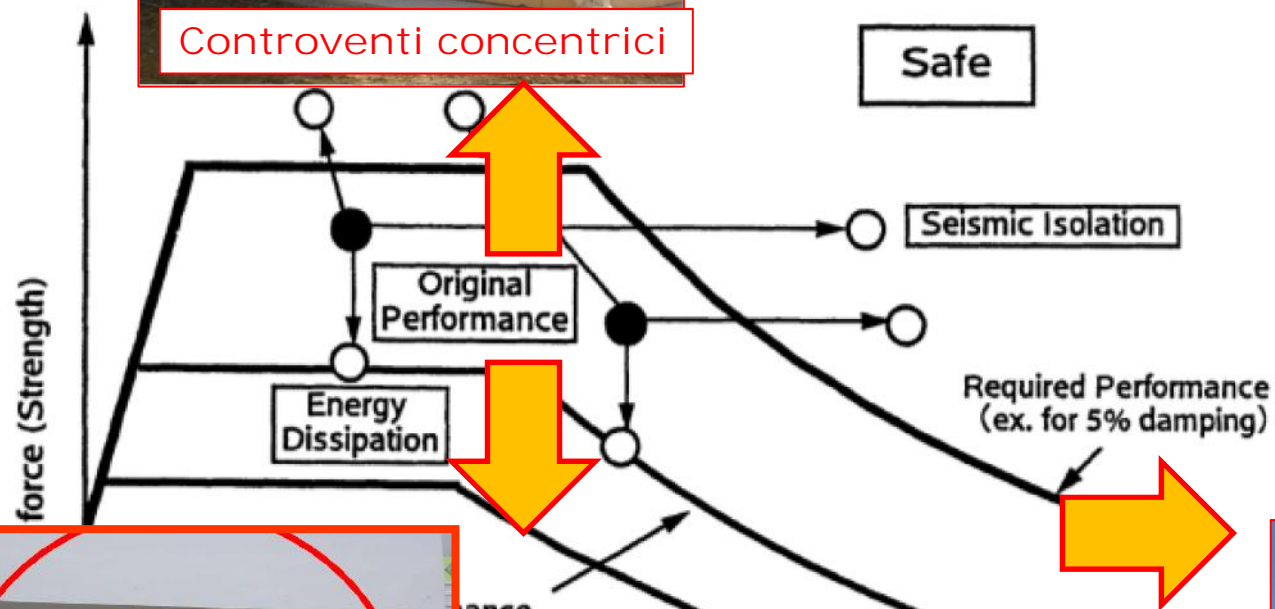

## Opzioni di miglioramento/adeguamento sismico

### INTERVENTI «GLOBALI»

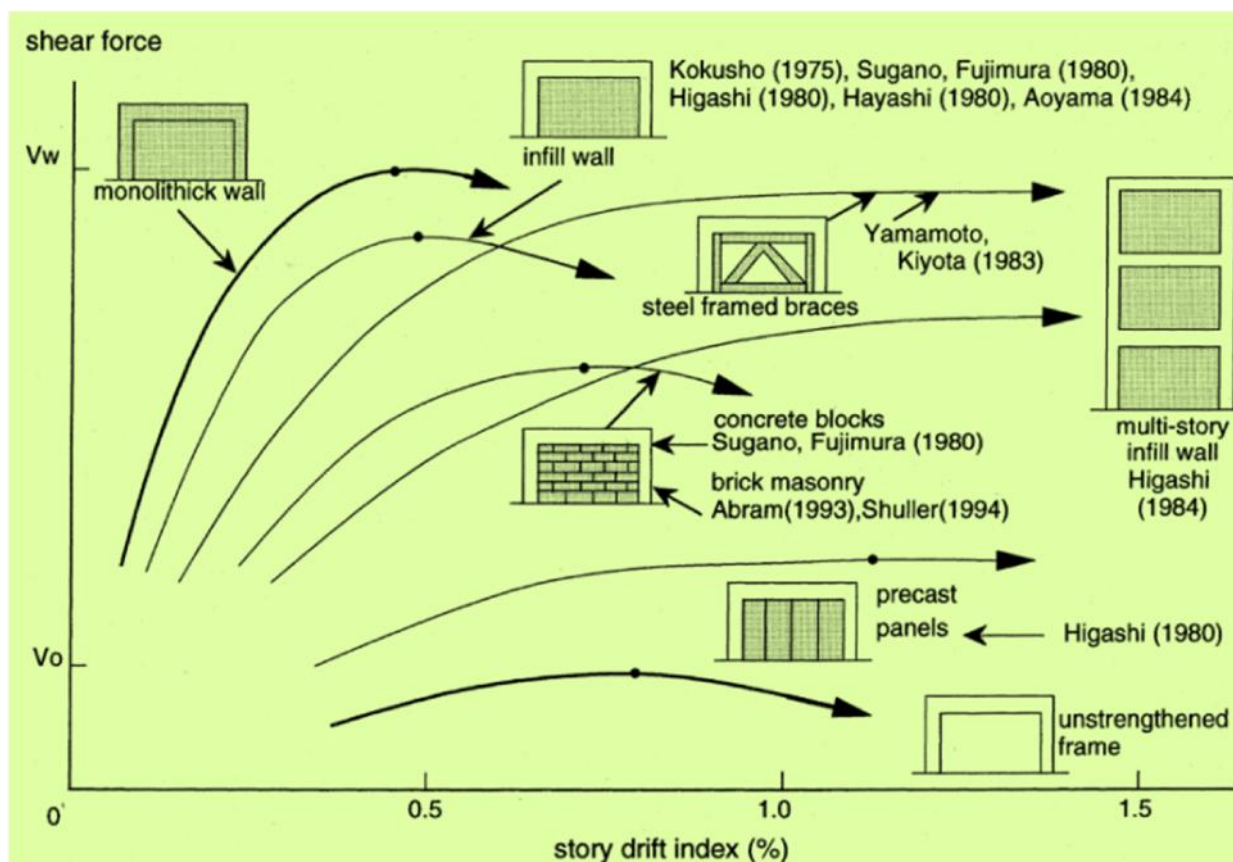
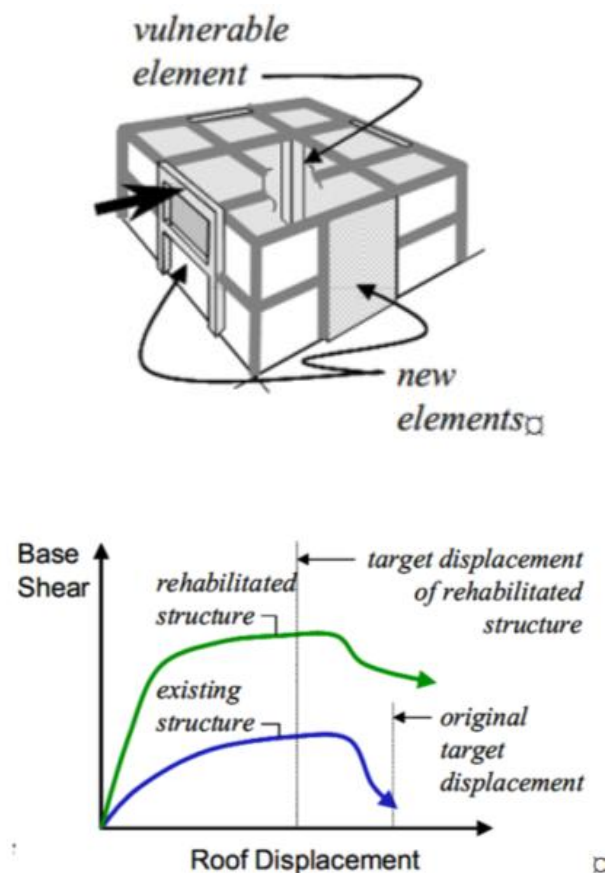



# Opzioni di miglioramento/adeguamento sismico

## INTERVENTI «LOCALI»

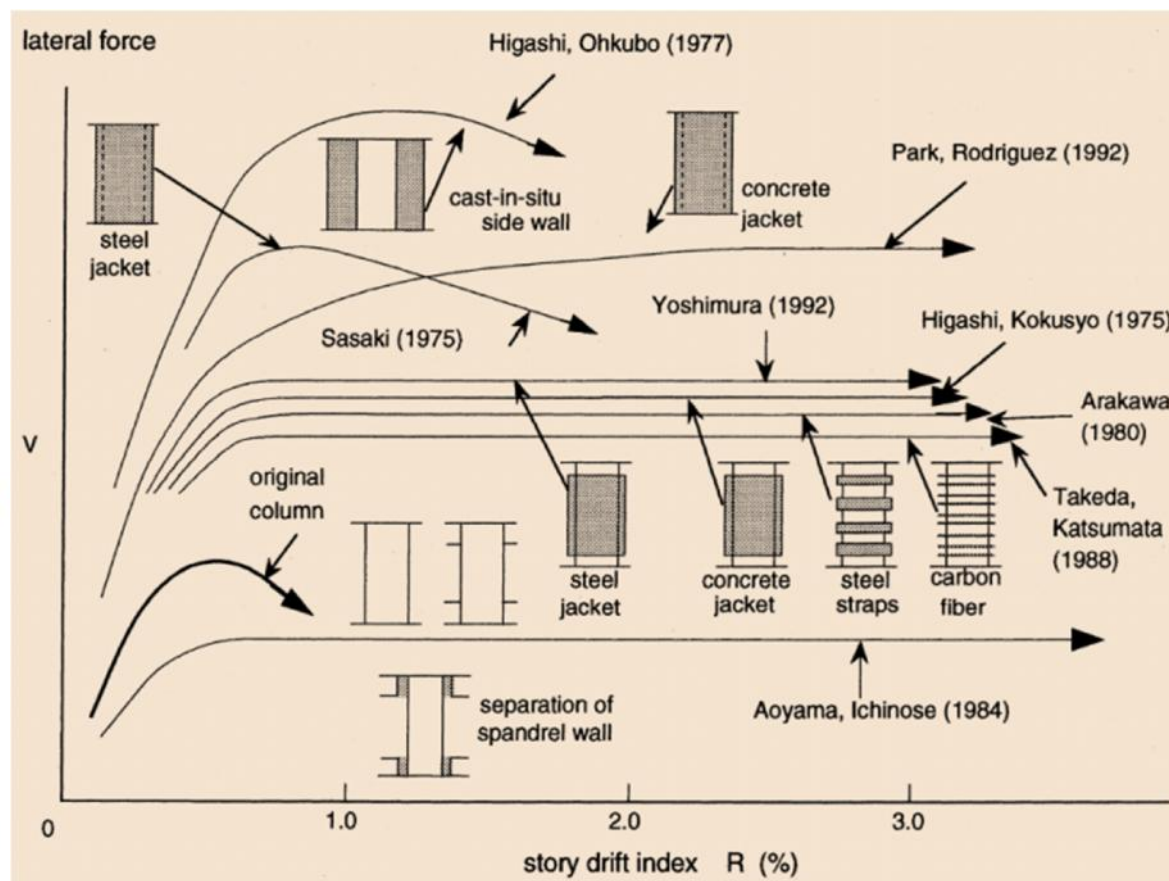
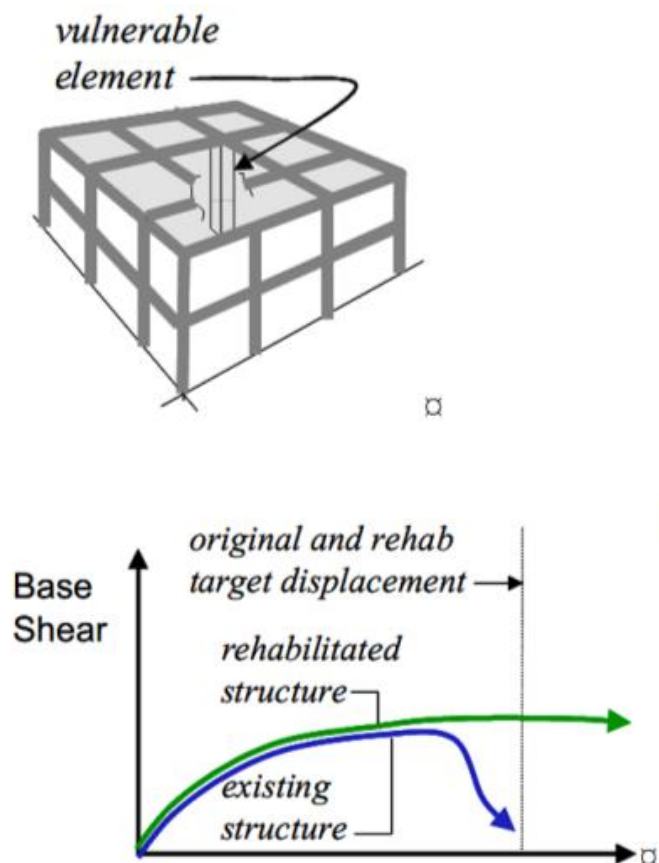

## Opzioni di miglioramento/adeguamento sismico

### INTERVENTI «GLOBALI»: ELIMINAZIONE DI IRREGOLARITÀ

Eccentricity between centers of mass and stiffness increase effects of torsion.

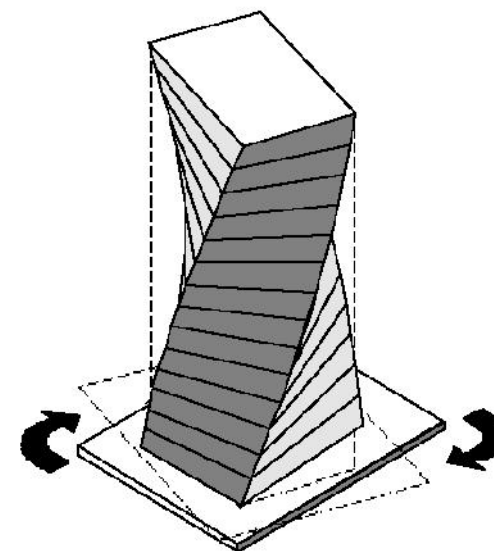
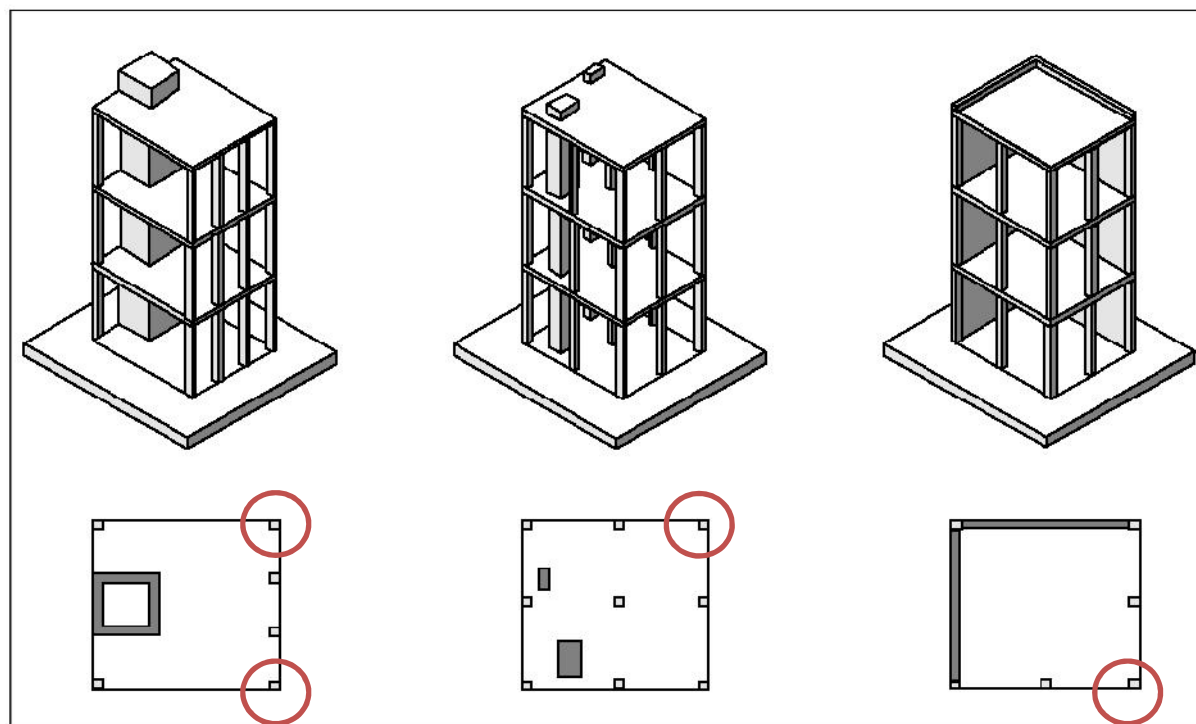

## Opzioni di miglioramento/adeguamento sismico

### INTERVENTI «GLOBALI»: ELIMINAZIONE DI CONFIGURAZIONI SCONVENIENTI

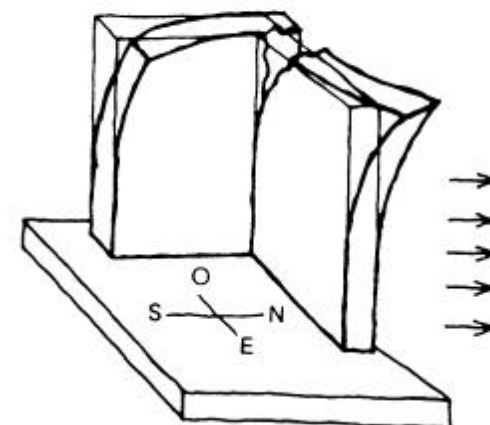
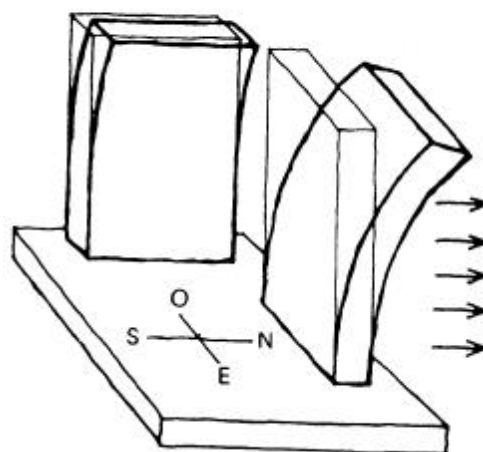
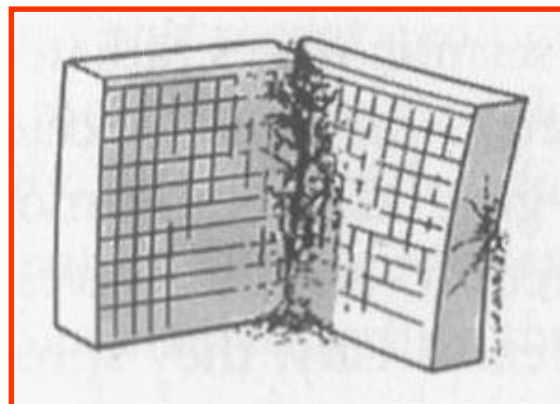
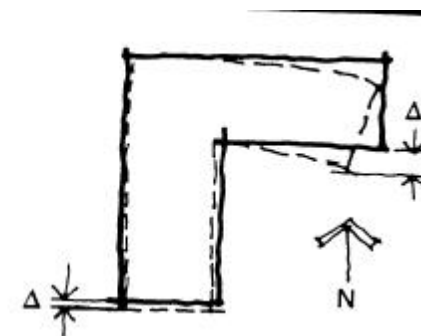
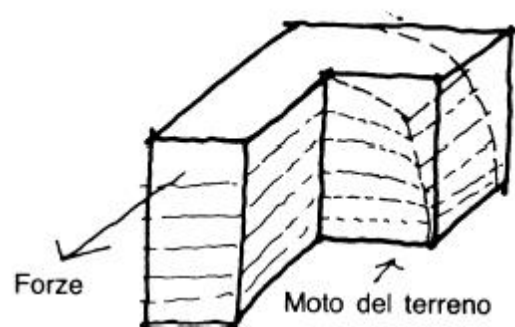
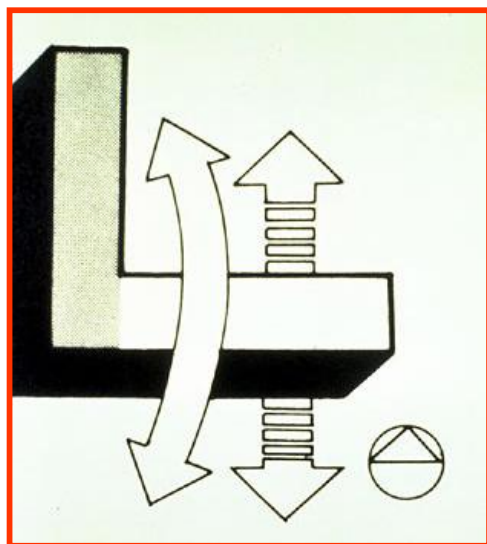

## Opzioni di miglioramento/adeguamento sismico

### INTERVENTI «GLOBALI»: ELIMINAZIONE DI CONFIGURAZIONI SCONVENIENTI

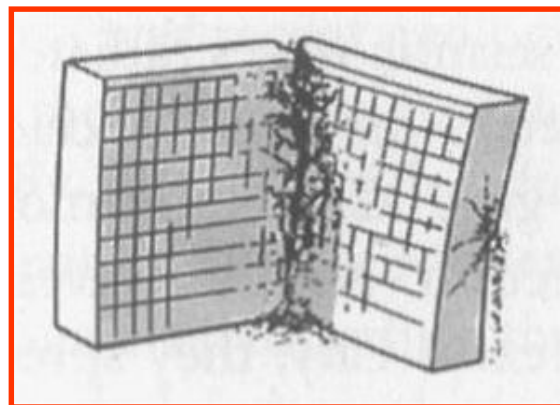
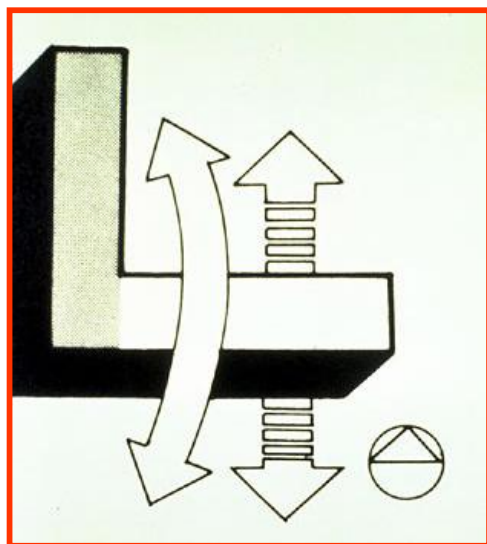

Soluzioni possibili

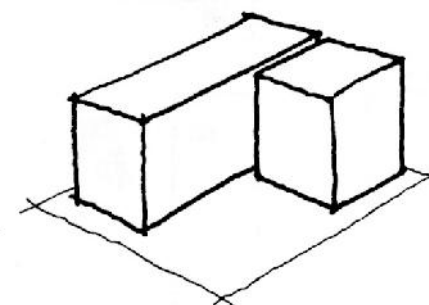
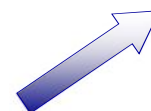

Separare in due l'edificio

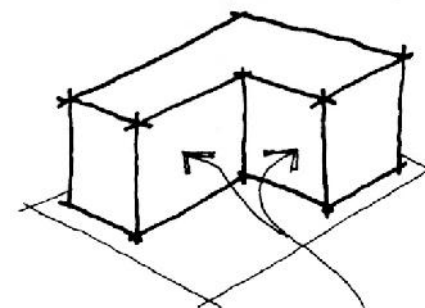
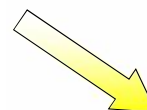

Legare bene insieme  
le due ali

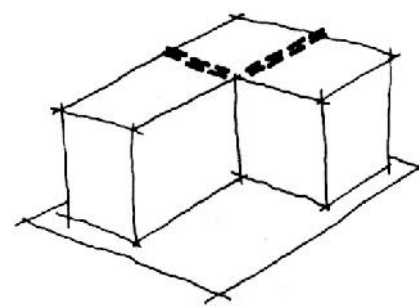

Collettori

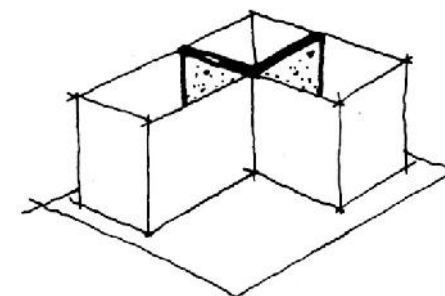

«Muri collettori»



## Opzioni di miglioramento/adeguamento sismico

### INTERVENTI «GLOBALI»: IRREGOLARITA' IN ALTEZZA - MARTELLAMENTO

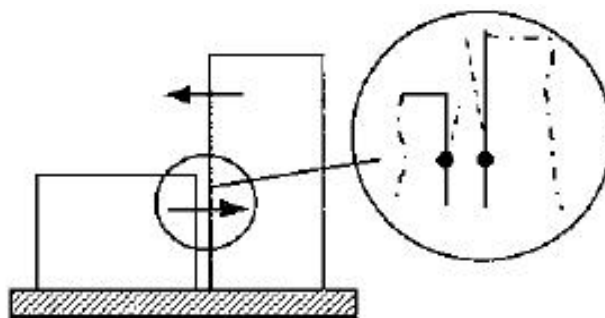
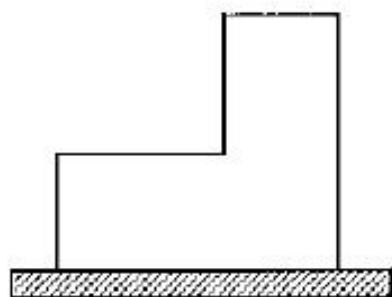
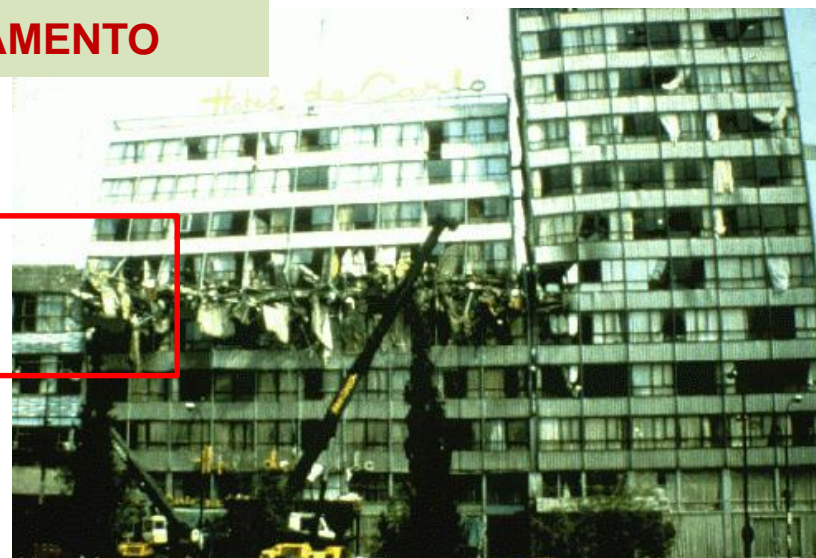

## Opzioni di miglioramento/adeguamento sismico

### INTERVENTI «GLOBALI»: ELIMINAZIONE DI «PIANI SOFFICI»

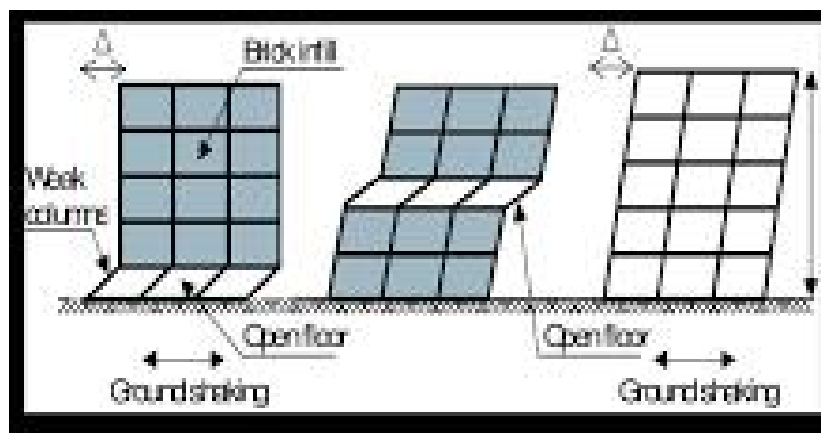
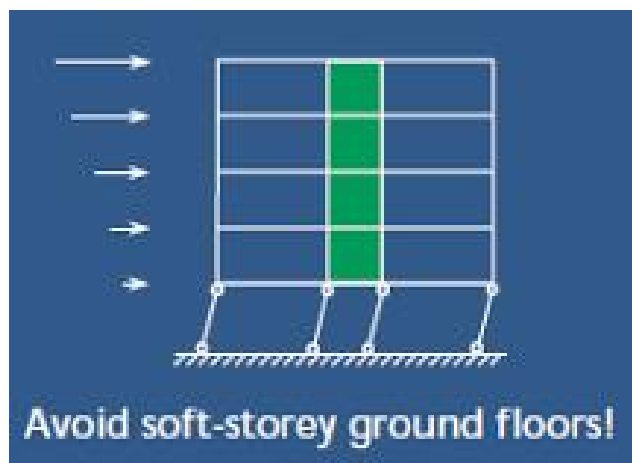

# GRAZIE PER L'ATTENZIONE

**Per contatti ed chiarimenti:**

**Ing. ROBERTO SCOTTA**

**Dipartimento ICEA – Università di Padova**

**[roberto.scotta@unipd.it](mailto:roberto.scotta@unipd.it)**